

32. Spot Map Light

A: REMOVAL

1) Disconnect the ground cable from battery. <Ref. to NT-5, BATTERY, NOTE, Note.>

NOTE:

For models other than STI model, disconnect the ground terminal from battery sensor.

2) Remove the light assembly - map.

CAUTION:

When using a flat tip screwdriver, apply protective tape or cloth and be careful not to cause damage.

(1) Release the claws and remove the lens.

(2) Remove the screws.

- Model without sunroof

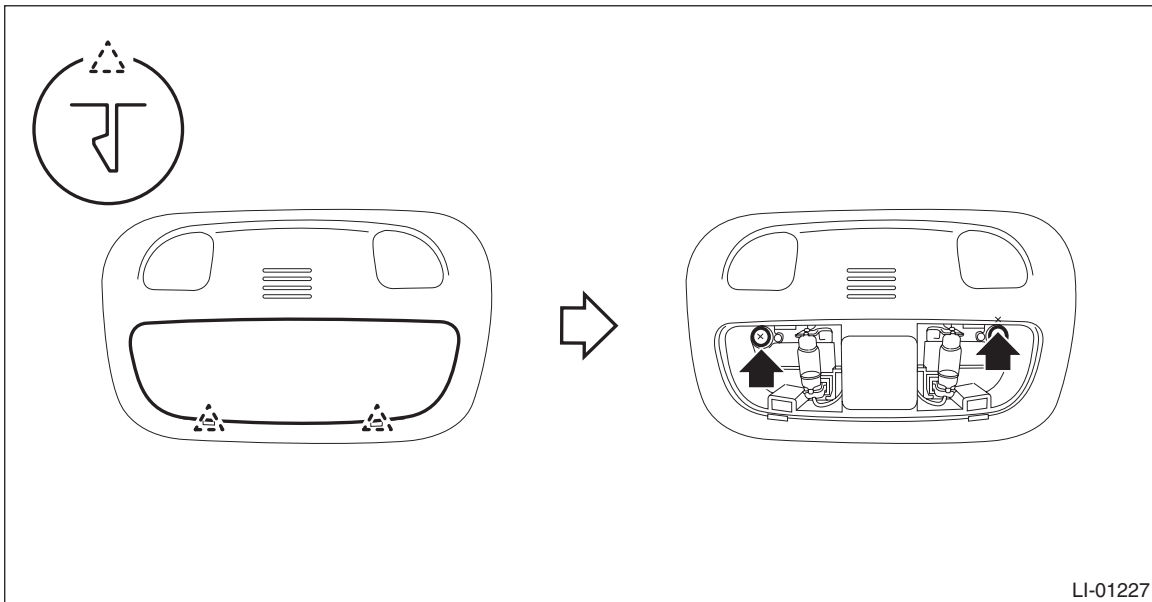

- Model with sunroof

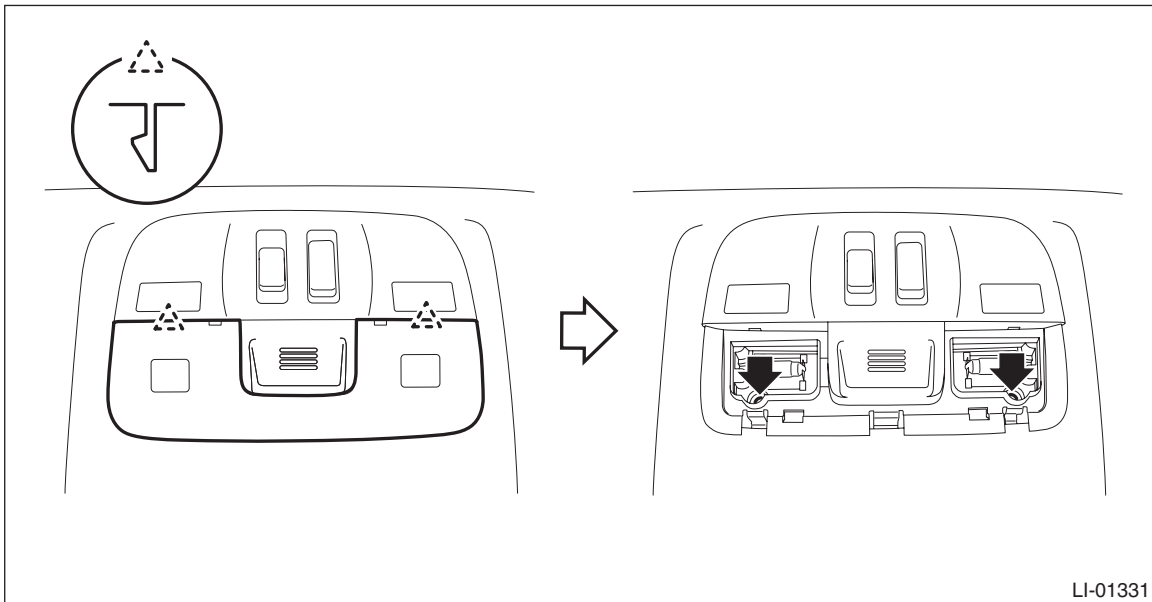

(3) Disconnect the connector and remove the light assembly - map and the map light bulb.

CAUTION:

Use a dry clean cloth so that no grease or water adheres to the glass portion of the bulb.

B: INSTALLATION

1) Install the map light bulb and light assembly - map.

CAUTION:

Use a dry clean cloth so that no grease or water adheres to the glass portion of the bulb.

2) Connect the battery ground terminal. <Ref. to NT-5, BATTERY, NOTE, Note.>

NOTE:

For models other than STI model, connect the ground terminal to battery sensor.

C: INSPECTION

1) Measure the resistance between connector terminals.

Preparation tool:**Circuit tester**

- Model without sunroof

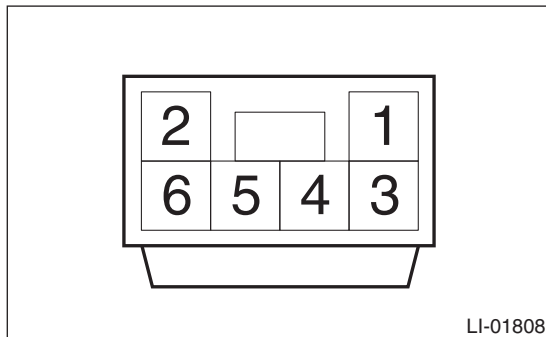

Terminal No.	Inspection conditions	Standard
1 — 2	Switch OFF	1 MΩ or more
	Switch ON	Approx. 18 Ω

- Model with sunroof

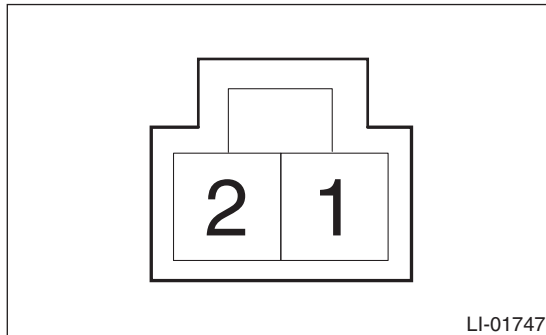

Terminal No.	Inspection conditions	Standard
1 — 2	Switch OFF	1 MΩ or more
	Switch ON	Approx. 18 Ω

2) Replace the light assembly - map if the inspection result is not within the standard value.